

# Pull-Away Valves for Transfer Operations

## A2141 Series

### Application

Designed especially to provide pull-away protection for LP-Gas and anhydrous ammonia transfer operations including transport and delivery truck loading and unloading, engine fuel container filling and miscellaneous cylinder filling operations. When properly fastened to the inlet end of the discharge hose, the valve is designed to stop gas escape from both upstream and downstream lines in the event of a pull-away. An excessive tension pull causes the valve to automatically separate, closing two internal back pressure checks. Only a few cubic centimeters of gas escape at the instant of separation.

It is recommended that a convenient means be provided to safely remove the pressure from the line upstream of each coupling half to enable reassembly of the valve. To reassemble, simply push the male half firmly into the female half until the retaining balls slip into the retaining groove. Check for leaks after reassembly.

NOTE: It is recommended that pull-away valves be maintained and safety tested periodically to confirm that they will separate properly in the event of a pull-away. Lubrication every six months is essential to the pull-away's operation. Dry nitrogen or other inert gas is suggested as a source of pressure for pull-away tests.

If the A2141 pull-away valve is going to be stored for a period of time, A2141 Series such as in seasonal applications, it is recommended that it be sprayed with a good grade of rust-preventive machine oil, and covered to protect it from moisture.

### Features

- Heavy-duty construction for long service life.
- A "true" pull-away type valve which simply reconnects by snapping together without unnecessary downtime or need for new parts.
- Buna-N seals provide leak tight operation.
- 400 PSIG operating pressure.

### Materials

Body (3/4", 1")..... Cadmium Plated Steel  
 Body (1 1/4", 2")..... Cadmium Plated Steel  
 Seals..... Buna-N Rubber  
 Cables ..... Nylon Coated, Galvanized Steel



**A2141A6**



**A2141A10**

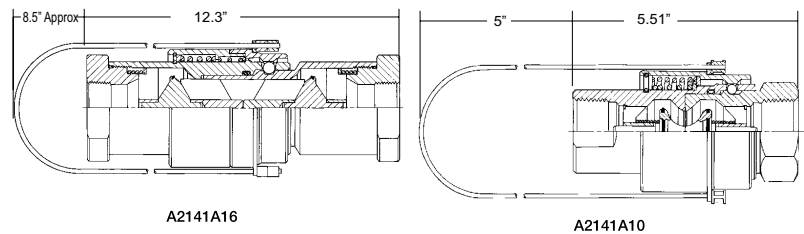
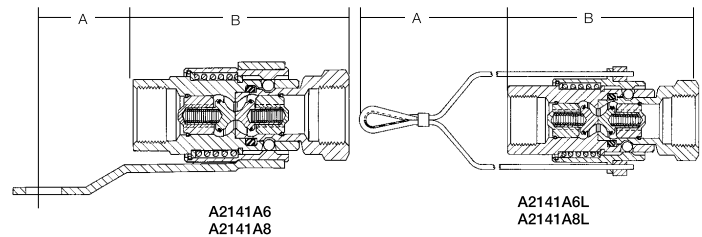

### Ordering Information

Part Number	Inlet/Outlet Connections NPT F.	Disconnect Force Approx-lbs	Reconnect Force Approx-lbs	Length A	Length B	LP-Gas Liquid Flow Capacity at Various Differential Pressures (GPM)*			
						5 PSIG	10 PSIG	25 PSIG	50 PSIG
A2141A6	3/4"	130	80	5/8"	3 3/8"	11	16	25	36
A2141A6L**				1/8"					
A2141A8	1"	75	50	1 15/16"	4 1/16"	21	30	47	67
A2141A8L**				5/8"					
A2141A10	1 1/4"	160	25	5"	5 5/8"	52	75	120	170
A2141A16	2"	300	50	8 1/2"	14 5/16"	250	350	550	750

\* To Determine NH<sub>3</sub> liquid flow capacity, multiply by .90.